

Health Effects of Modern Airtight Construction: Follow-on Funding

Overview of planned activities

Prof. Tim Sharpe, MEARU, Glasgow School of Art



HEMAC network: Priorities / recommendations

Research

- Need to establish an evidence base on the association between IAQ, ventilation and health in homes.

Policy and legislation

- Introduction of guidelines/standards for home IAQ, including measures to apply and regulate these where possible (e.g. rating systems, certification schemes)
- Improvements to UK building regulations and enforcement (particularly ventilation)
- Greater regulation of emissions from building products and materials
- Investment in public campaigns **to raise awareness of IAQ in the home**
- Greater investment in funding to support cross-disciplinary collaborative research
- Clearer provision of responsibility (and liability) of IAQ in domestic sector

Practice

- Provision of housing **design guidance** for architects and suppliers on source control, to include facilities to assist the sourcing of low emitting, non-toxic materials and products
- Improved **training and education** on the design, construction, operation and maintenance of ventilation provision for airtight housing, including potential risks and how to avoid these

Follow-on funding aims and objectives

The aim of the follow-on funding is to collate knowledge generated by the network and translate this into information that can be used by a number of different audiences

This includes:

- Information for occupants about sources of pollutants and effective ways of ventilating homes
- Specific information for particularly vulnerable occupants, through engagement with patient groups
- Design advice and guidance, and Continuing Professional Development (CPD) content for building designers and client groups
- Synthesis of research knowledge into advice and recommendations for policy advisors, design legislation and advocates

Activities: Public Consultations



- Consultations with respiratory patients to identify research priorities from patient perspective and develop bespoke guidance
- Provide bespoke advice on key issues of source control and use of ventilation strategies for specific patient groups
- Provide a platform for knowledge exchange between respiratory patients and researchers to share ideas and experiences
- Acquire knowledge in context to inform and strengthen on-going, proposed and/or future research involving respiratory patients and increase the potential impact and value of the findings

Activities: Home User Guide

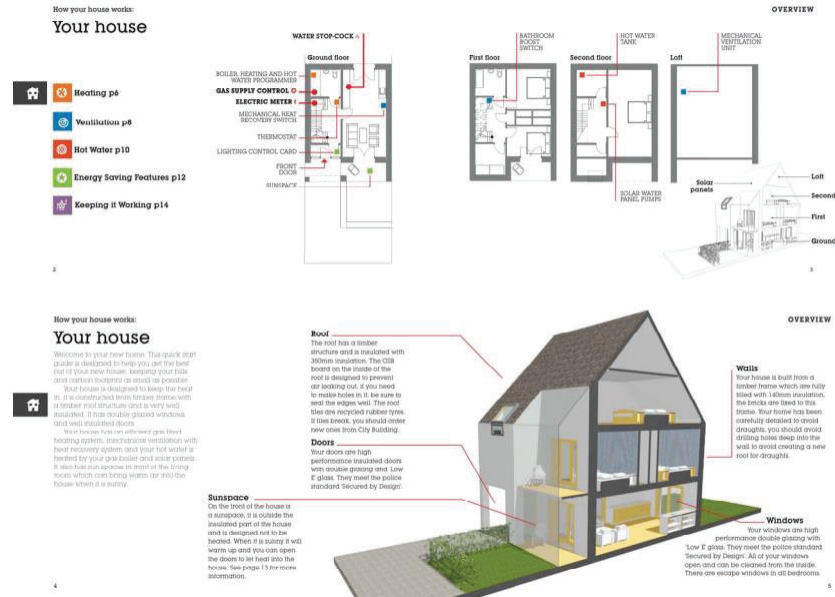

- Development of a home user-guide to provide information and advice on IAQ & ventilation
- Used as stand-alone guide or incorporated into existing new home Handover packs
- Will include graphical and textual information on types & sources air pollution and on operation of ventilation
- User guides will be implemented in on-going BPE projects and distributed among network
- Launch event

Activities: Professional Guidance

Aim

- Provide practical, informed guidance and training to architects and construction industry professionals on source control and ventilation
- To raise the agenda of IAQ among professionals and provide new skills sets to increase capacity of the construction section to deal with these emerging issues

Professional guidance will consist of:

- Develop design guide / best practice guide for building professionals (and clients) on source control and ventilation in airtight homes.
- Develop content for CPD courses and host an initial CPD event for practicing architects to test content and to launch the design guide.

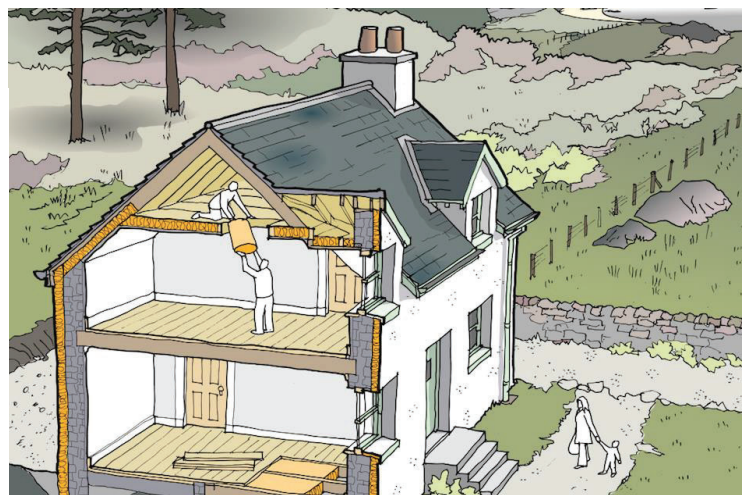
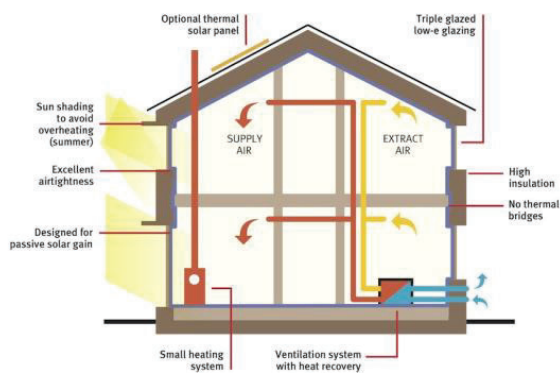

Design and Detailing for Toxic Chemical Reduction in Buildings

SEDA Design Guides for Scotland : No. 3

Activities: Policy Engagement



- To ensure widespread impact there is a need to effect policy and regulation in construction and design, through revised building standards and codes of practice.
- The policy roundtable event will:
 - Help to bring together policy actors from various sectors to deliberate how to work together to ensure delivery of homes that are both energy efficient and healthy
 - Provide a forum for knowledge exchange between researchers, practitioners and policymakers
 - Establish key priorities and recommendations for policy makers to advance health care provision, building policies and industry standards for ventilation, IAQ and energy in housing.

Final remarks

(Questions and Answers)